

### Intended use

Seat height adapters are used to raise the seat height by 30 or 50 mm.  
Note that all pictures in these instructions show the adapters for 50 mm.

### Parts included

1 x adapter plate  
RH



1 x adapter plate  
LH



1 x gas spring holder



6 x screw



6 x washer 2 mm



6 x nut



2 x washer 1 mm



4 x bushing



### Assembly

**Note: This assembly requires technical proficiency.**

Preparation: Check that the seat is level, not tilted. Remove all accessories, arm rests, cushions, and drive wheels. Place the wheelchair on a work bench or similar. Ensure that the wheelchair is in a stable position, preferably with both castors forward.

Check that the adapter plates and all parts are present. Identify LH and RH parts and place them on each side of the wheelchair so that they are at hand as needed.

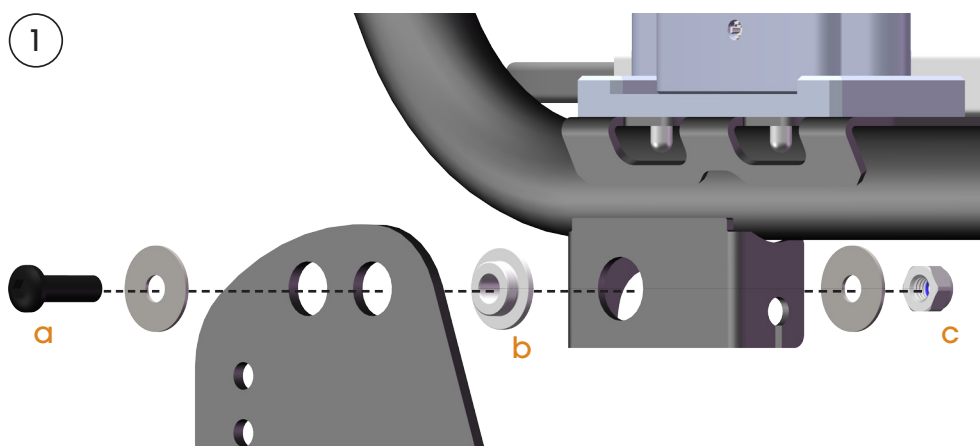

**Step 1:** See Figure 1. Remove the nut and washer (c) at the seat frame pivot point on each side. Leave the screws (a) in place to support the seating unit.

**The next step requires extreme care.** The assembly is made much easier with a helper holding the push bar to balance the seating unit. If no helper is available the seating unit must be supported so that it does not fall when the screws are removed. In this case there is a significant risk for personal injury or damage to the wheelchair (particularly the cables and the gas spring attachment points).

Remove the screws and washers (a). The joint bushing (b) will be re-used. It may remain in place in the seat frame. The other parts will be replaced.

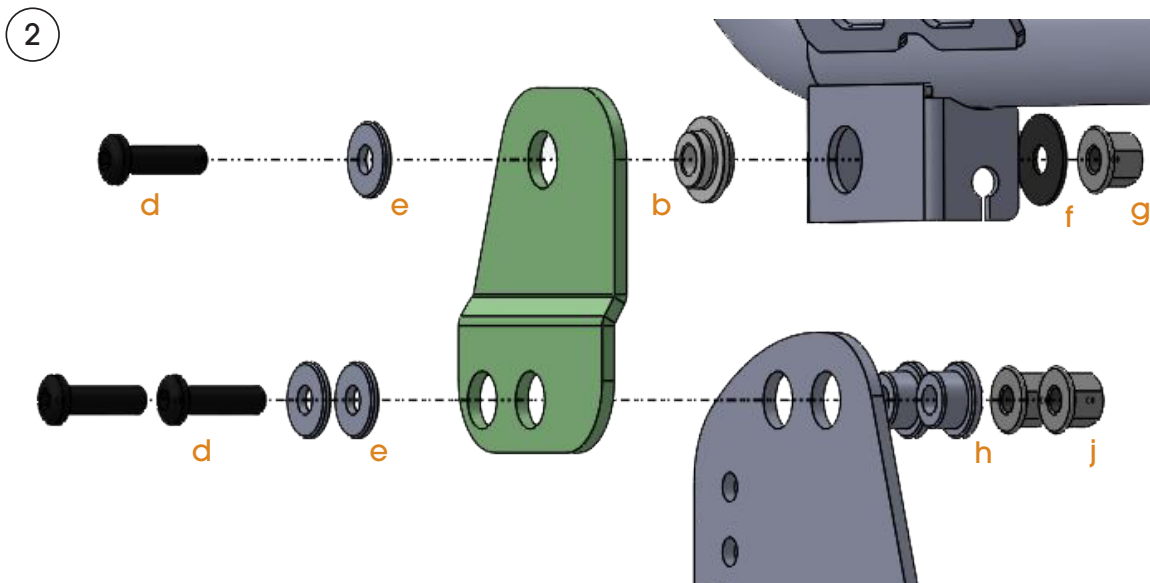

**Step 2:** See Figure (2).

Check that the correct adapter plate is being assembled.

Set in the bushings (h) through the holes in the wheel frame from the inside. Mount the adapter plate with the screws (d) and washers (e).

Screw on the nuts (j) but do not fully tighten, the adapter plate needs some flexibility. Mount the adapter plate on the other side.

**Step 3:** See Figures (2), (3) and (4).

Place the seat frame in place so that the joint bushings (b) fit into the upper holes of the adapter plates.

Assemble the screw (d) and washer (e), and then the washer (f) and nut (g) from the inside. Tighten only by hand.

Repeat these steps on the other side of the wheelchair. The seating unit is thus secure and a helper is no longer needed.

Tighten all nuts on both sides. Check that the joint bushings (b) are properly seated.

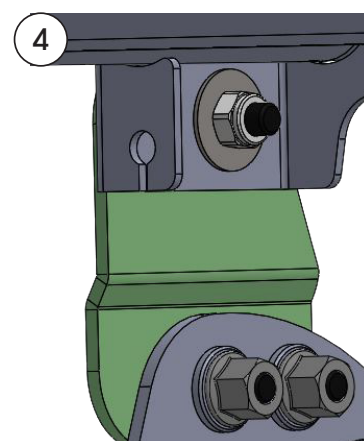
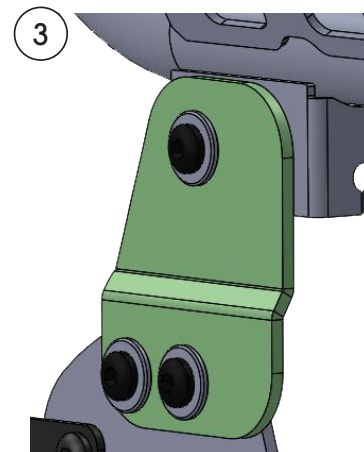

**Step 4:** Replacement of gas spring holder.

See Figure (5).

Loosen the nut (n) a few turns. Take apart the bolt connection at the bottom of the gas spring holder and remove all components (p, q, r, and s).

Remove the circlip (m) at the wheel frame attachment.

**Note:** Be careful that the circlip is not damaged (opened too far) so that it can be re-used. Remove the joint pin (k). The holder can then be removed by pulling it down from the gas spring.

The new holder is assembled in the reverse order. Push the holder up over the gas spring, attach with the joint pin through the wheel frame. Check that the circlip (m) is properly seated.

The bolt connection is assembled per Figure (5).

For 50 mm adapters use the lower slot in the holder, for 30 mm adapters use the higher slot (see Figure (6)).

Do not fully tighten the nuts (n) and (p). This is done after adjustment of the seat plate zero position, which is done on flat ground with the wheels mounted.

For detailed information on adjustment of the seat plate zero position and the gas spring attachment in the holder see *Technical Information* sections 2.4, 2.5 and 2.6 (document number 96720-1).

Check the functions of the wheelchair before it is used.

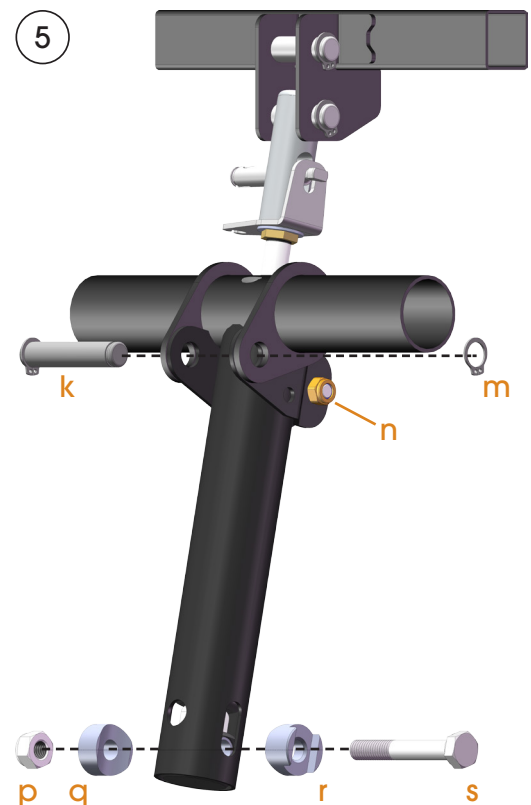

## Use and Care instructions

Depending on the user a check should always be done after mounting height adapters to see if there is an increased tipping risk.

Always replace damaged parts immediately. For more information see *Maintenance Instructions*, document number 96730-1.