

# Respine

► Manual | English

## GENERAL INFORMATION

Respine is a class 1 CE-marked medical device.

### Intended use

Respine is a sitting support intended to be used by people with neck disorders. Respine is to be used in situations which requires sitting for longer periods of time in environments where specially adapted sitting furnitures do not exist. The product shall ease the symptoms that may occur when sitting, for people with neck disorders.

Respine is portable and intended for use (mainly for passive sitting) in various indoor environments e.g. on chairs in meeting facilities, cinema and theatre auditoriums and on chairs by dining tables in home environments. The product is not intended for use in vehicles or in other means of transportation.

### Delivery control

- Make sure there is no visible damage to the product.
- Any transport damage must be reported immediately to the transport company.

#### Components in the product packaging

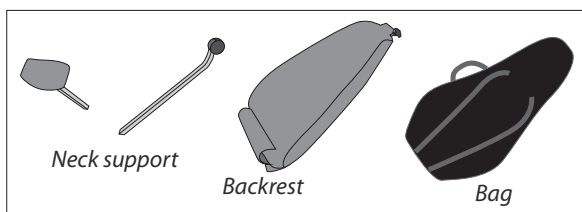

Weight:	850 g
Dimensions, folded:	8 x 28 x 51 cm

## General safety

Before using Respine it is important that you read the manual.

- Always check before using Respine that it's steady and straight leaning against the backrest of the chair. Respine do not fit in all sitting furnitures. For example, it may be less functional on soft or unstable furnitures. Always be alert and careful when you sit down so that Respine not overturns.
- Sitting upright is the most beneficial posture for the back and neck, but more important is to sit variedly. Change position often. Be careful not to sit in a way that makes you tense. Sit comfortably. If you experience that symptoms from your neck injury become worse when using Respine, stop using Respine and consult a physiotherapist or equivalent.
- Respine is designed to be light and flexible and can therefore not be hanled roughly. Handle it with care both during sitting, transportation, and the adjustment of the various functions.
- Be aware of the risk of pressure sore that can occur if you sit too long without changing position. If you have loss of sensation, you should be extra vigilant when using Respine as there is a risk that you will not notice if you get pressure sores.
- If the product is damaged or worn out, this must be fixed. Depending on the extent of damage, the product should be taken out of service until repairs have been carried out or worn parts are replaced.

## Warnings

In addition to what is mentioned above in “General safety” are more situations you should be aware of. See pictures below. Even in other sections of the manual, there are more warnings. Read them carefully. They are marked with this symbol: 

Be aware of the following situations:

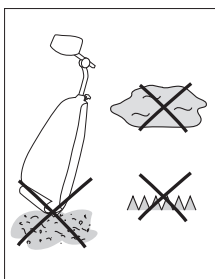
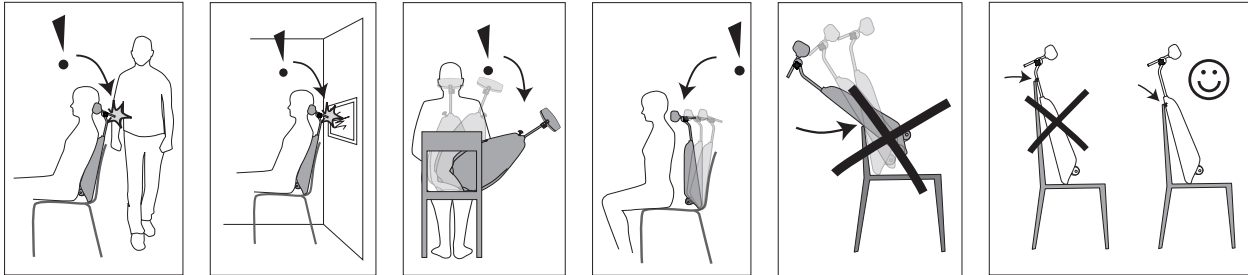

Do not use on rough and dirty surfaces.

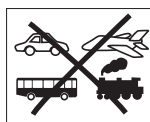

Do not use Respine in vehicles.

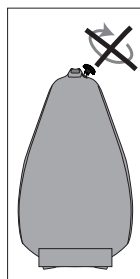

Do not tighten this knob if keeping the backrest without the neck support inserted. This can damage the entrance of the neck support.

Don't let the neck profile lean against the backrest of the chair.

## IDENTIFICATION OF THE PRODUCT / MARKINGS



This label shows that Respine is a CE-marked medical device and who is manufacturer. REF stands for article number.



Manufacturer and batch number (date of manufacture: YYMMDD) is specified on the inside of the backrest.



Washing instructions

 = No spin-drying

## USAGE

### Mounting

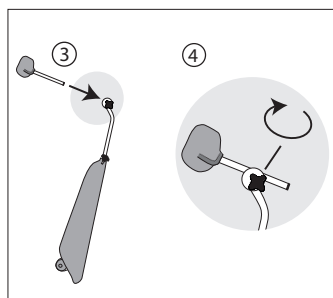
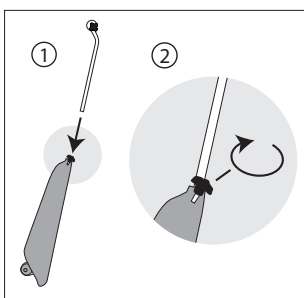

The knob, fig. 4, can be mounted right or left.

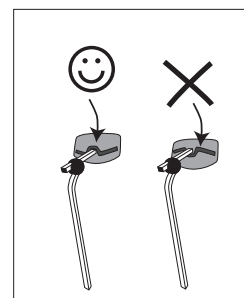

Mount the neck cushion so the wide part of the cover closing is upward.

## Usage on sitting furniture

### Leaning against backrests

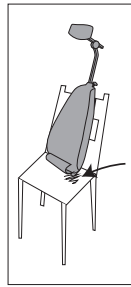
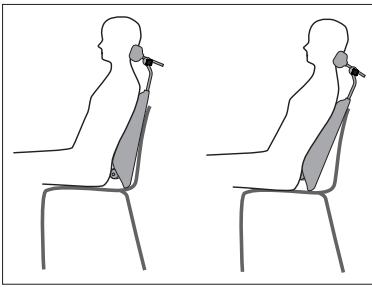

Be careful with sensitive furnitures.

With Respine you can sit both upright and in a slightly reclined position..

## Adjustments

### Height adjustment of the lumbar support

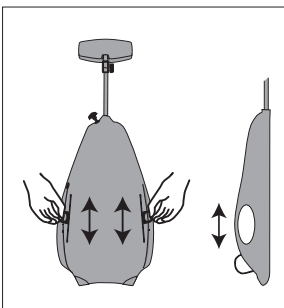

### Depth adjustment of the lumbar support

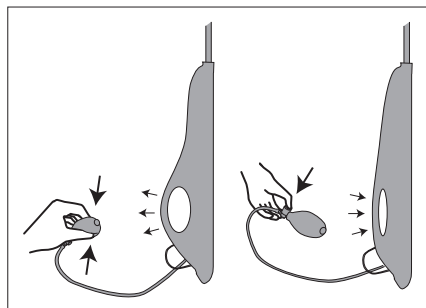

If the hose is folded it can be heavy to pump. Pull the hose to smooth out any folds. If this doesn't help the air bag is probably starting to become full. Always stop pumping when the air bag is getting full.

### Depth adjustment of the neck support

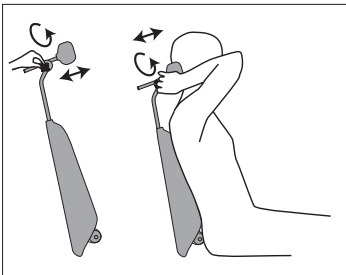

### Height adjustment of the neck support

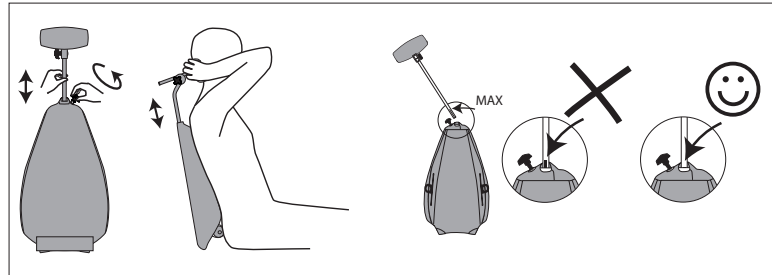

Do not tighten any of the knobs harder than necessary.

You can choose to tighten the knob just so hard that the height of the neck support can be adjusted while sitting.



The neck support must not be set so high so that the red mark becomes visible, as the picture above shows. This is due to the risk of deformation.

### Angle adjustment of the neck support

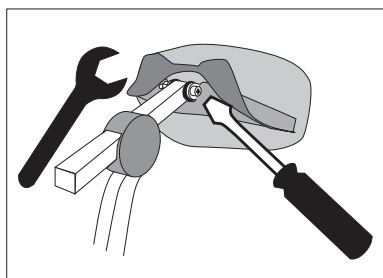
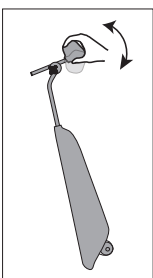

The toughness of the tilting can be adjusted if necessary.

### Removal of plastic sheet

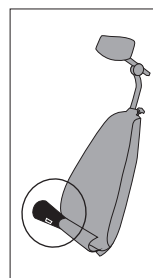

This plastic sheet can be removed if necessary.

## Storage and transport

Avoid dirty and humid environments. Store Respine dry. If the product will be sent it shall be well-packed, preferably in the original packaging.

If the product has become cold during transport it shall reach normal room temperature before use.

Storage in attached bag

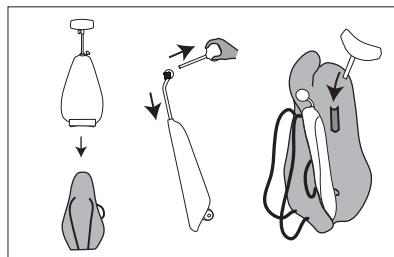

## MAINTENANCE

Respine should be cleaned when necessary. Hard components can be washed/wiped with mild detergent. Avoid harsh detergents as they may damage the product. The cover should primarily be wiped clean. The cover can also be washed in water. Washing instructions are found inside the zip. The cover shall be washed by hand and must NOT be centrifuged. Respine should be cleaned if changing user.

Removal of cover before washing

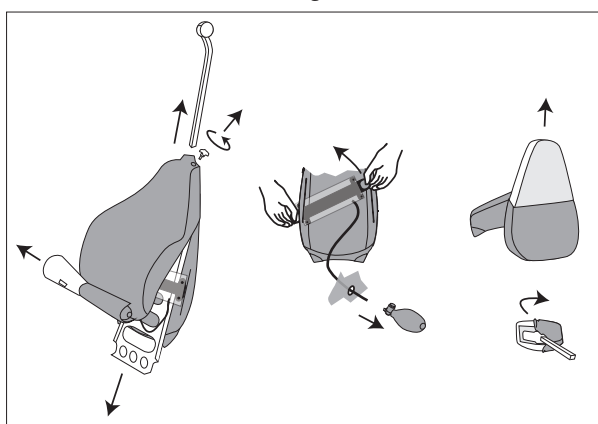

Remove the cover from all components. If the pump is hard to loosen the hose can be cut off right next to the pump.

Mounting of the neck cover after washing

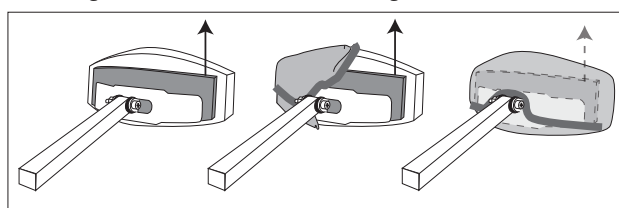

Let the wide border of the hard foam face upwards when you put on the cover in the direction as shown.

## RECYCLING

Cover, foam and pump are recycled as combustible materials. The remaining components are recycled as metal waste.

## WARRANTY AND ESTIMATED LIFETIME

The warranty is valid for 2 years. The manufacturer is solely responsible for the reliability and performance of the product if it is used for the intended purpose and under the provision described in the manual. If the above is not followed carefully the warranty is considered not valid. Respines estimated lifetime is 4 years at normal use. This is provided that the product is handled and maintained according to instructions.

## Manufacturer:

Hantverksdesign & Rehabiliteringsprodukter AB  
Tryffelslingan 4  
SE-181 57 LIDINGÖ  
SWEDEN  
www.hdrehab.se  
info@hdrehab.se



### DOCUMENT INFORMATION:

ART. NO. : 95901-1  
REVISION: B  
PUBLICATION DATE: 2011-10-20