

Conversion Kit Tilt plates HD Balance

Appendix to Spare parts

Art.no: 69951-6 Seat height +5 cm

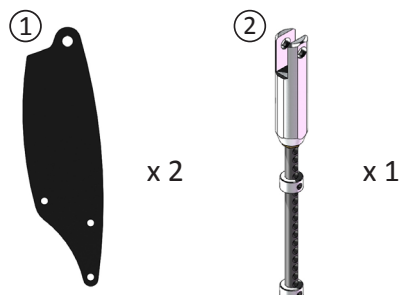

1. art.no: 67052-6 Tilt plate extended +5 cm
2. art.no: 67827-1 Tilt bar +5 cm standard

Art.no: 69952-6 Seat height lowered 3 cm

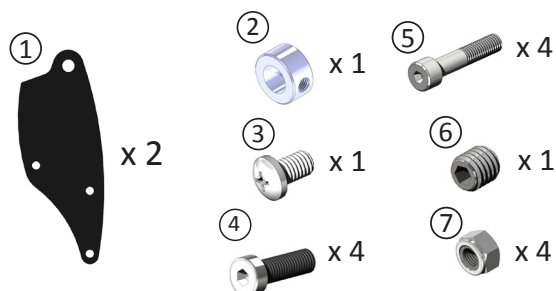

1. art.no: 67053-6 Tilt plate lowered 3 cm
2. art.no: 11038-5 Stop ring for Tilt bar
3. art.no: 81121 Screw MRX 6x10 FZB
4. art.no: 81233 Screw MLC6S M8x25
5. art.no: 81247 Screw MC6S M8x40 FZB
6. art.no: 81305 Screw SK6SS 6x6
7. art.no: 81523 Locking Nut M8 FZB

Art.no: 69953-6 Seat height +5 cm
+ increased tilt 0-30°

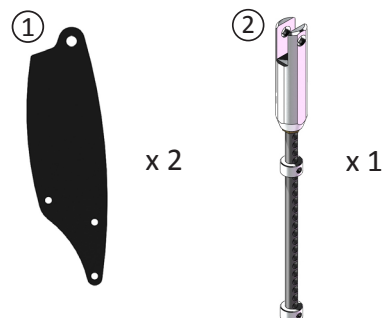

1. art.no: 67052-6 Tilt plate extended +5 cm
2. art.no: 67828-1 Tilt bar +5 cm extended

Art.no: 69956-6 Forward mounted seat 3 cm

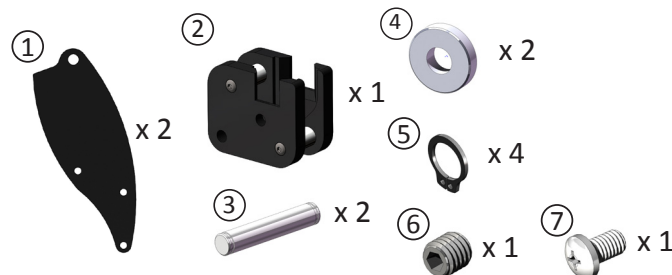

1. art.no: 67056-6 Tilt plate forward 3 cm
2. art.no: 67070 Adapter forward mounted
3. art.no: 67072-1 Pin for adapter
4. art.no: 11101-6 Spacers for gas spring
5. art.no: 81731 Circlip SGA 10
6. art.no: 81305 Screw SK6SS 6x6
7. art.no: 81121 Screw MRX 6x10 FZB

Art.no: 69957-6 Back mounted seat 3 cm

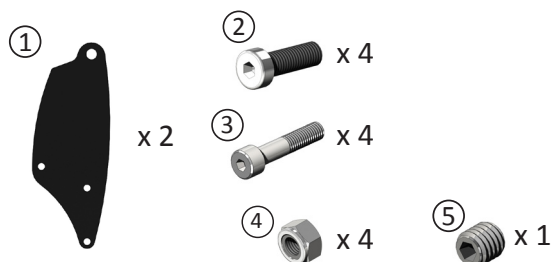

1. art.no: 67057-6 Tilt plate back 3 cm
2. art.no: 81233 Screw MLC6S M8x25
3. art.no: 81247 Screw MC6S M8x40 FZB
4. art.no: 81523 Locking Nut M8 FZB
5. art.no: 81305 Screw SK6SS 6x6

Art.no: 69959-6 Back 3 cm & lowered 3 cm

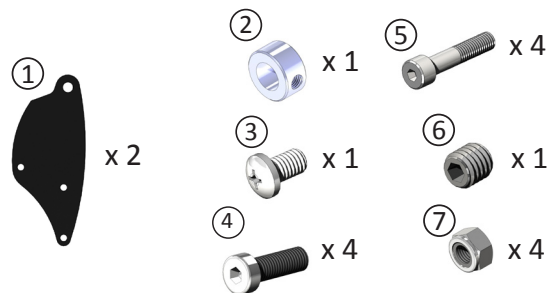

1. art.no: 67059-6 Tilt plate back 3 cm & lowered 3 cm
2. art.no: 11038-5 Stop ring for Tilt bar
3. art.no: 81121 Screw MRX 6x10 FZB
4. art.no: 81233 Screw MLC6S M8x25
5. art.no: 81247 Screw MC6S M8x40 FZB
6. art.no: 81305 Screw SK6SS 6x6
7. art.no: 81523 Locking Nut M8 FZB