

ASSEMBLY INSTRUCTION

Fastening for wide Flexi Back: s/w45 on Wheelchair s/w38, or Flexi Back s/w45 on Wheelchair s/w38

Art.no. 14254-1



The kit includes the following parts:

- | | |
|-----------------------|-------|
| 1. Bolt | 4 pcs |
| 2. Washer | 4 pcs |
| 3. Flexi back bracket | 4 pcs |
| 4. Screw | 4 pcs |
| 5. Nut | 4 pcs |

These tools are needed:

- Allen key, size 3 mm.
- Open-end spanner, size 13 mm.
(Alt. HD-tool, 10-13 key.)

Fit as follows:

1. Remove existing back plate or Flexi back, and existing back plate brackets.
2. Fit the new Flexi back brackets (3) onto the back frame (7). Make sure that they are placed as shown in figure 1 and 2. Tighten the screws (4) slightly, but not completely.
3. Fit the Flexi back (6) onto the four Flexi back brackets (3) using the bolts (1), washers (2) and nuts (5), see figure 1 and 2. Do not tighten the screws completely. *(The Washer (2) is used only on wheelchairs without thoracic supports. On wheelchairs with thoracic supports, the supports are placed between the Flexi back and the Flexi back brackets, see separate assembly instruction, art.no: 95162. Note that special thoracic support attachments are required for the wide flexi back)*
4. Put the push bar back into the back frame to make sure that the shape of the back frame is not changed.
5. Position the upper Flexi back brackets (3) about 3 cm below the top edge of the back frame (7) and the lower Flexi back brackets about 23 cm lower on the back frame, see figure 2. Make sure that everything is in the right position and in the right angle.
6. Tighten all nuts and screws securely.
7. Fit the wire control unit onto the Flexiback according to the separate assembly instruction, art.no: 95162.

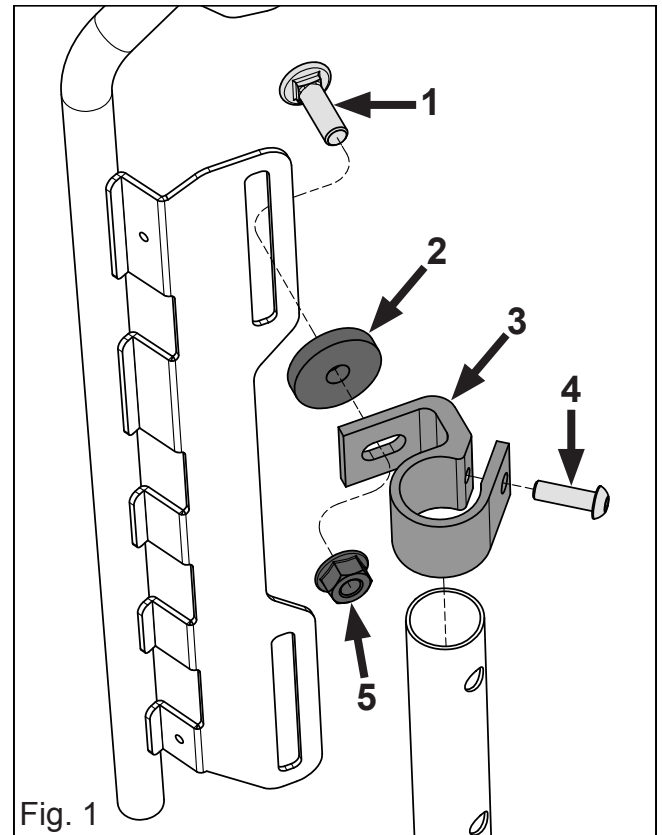

Fig. 1

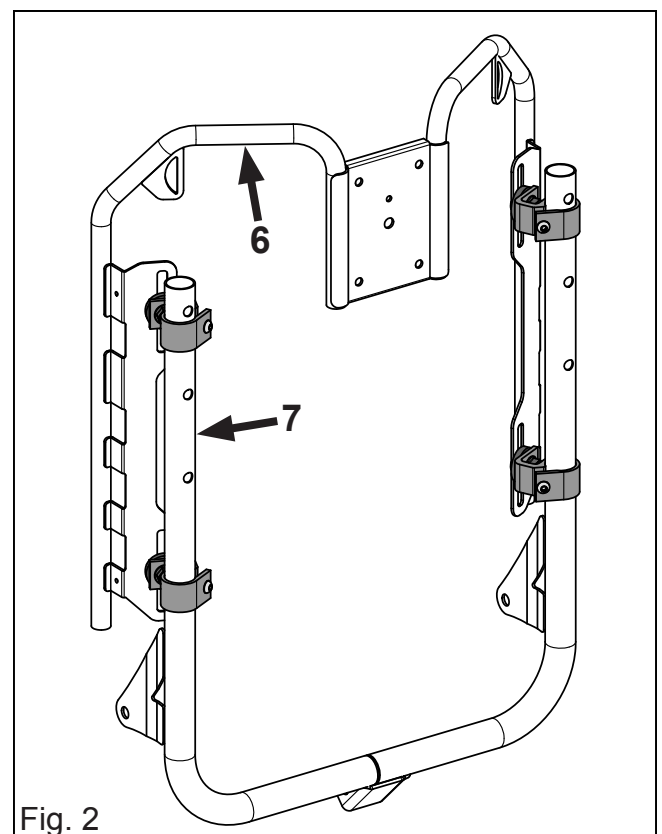

Fig. 2