

# ASSEMBLY INSTRUCTION

## Adapter kit, art.no: 11536-1

### Lowering of the cross bar



#### Use:

The kit is used with wheelchair model HD-500, in case of increased seat tilt or when the seat height is decreased by using a lower connection point for the seat frame on the wheel frame.

#### Step 1:

Detach the cross bar (1) by loosening the screws (2). (To reach the screws (2), rotate the brake discs (3) so that the oblong hole in the brake discs align with the screws.) Please note: The screws (2) must not be reused.

- See figure 1.

#### The kit includes the following parts:

(1-3 are existing parts on the wheelchair.)

4. Washer	2 pcs.
5. Screw	2 pcs.
6. Screw, countersunk	4 pcs.
7. Nut	4 pcs.

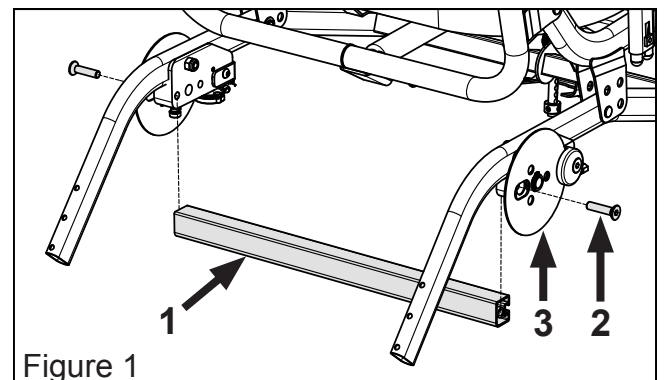

Figure 1

#### Step 2:

Fasten the washers (4) on the cross bar (1) using the screws (5). Place the in-bent part of the washers inward, toward the cross bar. The washers must be placed parallel to each other: This is done by putting the cross bar with the washers on a flat surface, resting on the top edge of the washers and, in that position, tightening the screws securely.

- See figure 2.

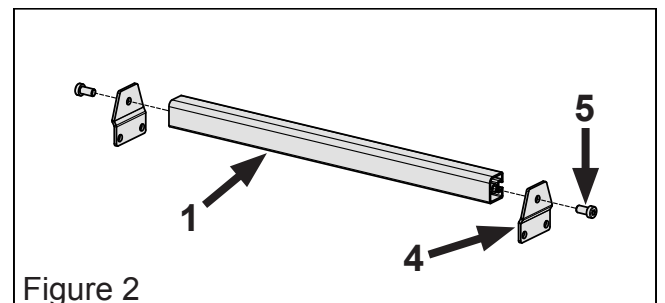

Figure 2

#### Step 3:

Fasten the cross bar, with the washers attached, on the wheel fastenings using the countersunk screws (6) and the nuts (7). Rotate the brake discs (3), in the same manner as in step 1, to place the screws. Tighten the screws securely.

- See figure 3.

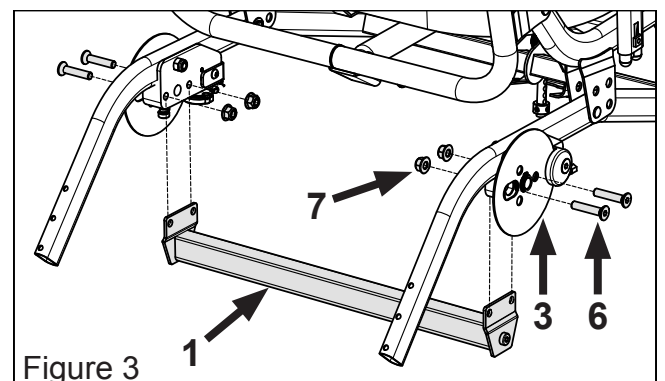

Figure 3